

WAREHOUSE TRUCK

FULL LINES



TOUGH WORLD. TOUGH EQUIPMENT.

Guangxi LiuGong Machinery Co.,Ltd.
No. 1 Liutai Road, Liuzhou, Guangxi.
545007
PR China
T: +86 0772 3886124
E: overseas@liugong.com
HQ: www.liugong.com
MH: www.lgforklift.cn

Like and follow us:



LIUGONG 082019-ENG

The LiuGong series of logos herein, including but not limited to word marks, device marks, letter of alphabet marks and combination marks, as the registered trademarks of Guangxi LiuGong Group Co., Ltd. are used by Guangxi LiuGong Machinery Co., Ltd. with legal permission, and shall not be used without permission. Specifications and designs are subject to change without notice. Illustrations and pictures may include optional equipment and may not include all standard equipment. Equipment and options varies by regional availability.

TOUGH WORLD. TOUGH EQUIPMENT.



Li-ion Pallet Truck

Main Features



HIGHT PERFORMANC

- Standard lithium battery, maintenace free.
- Hight capacity battery and quickly charger for option.
- Inside BMSCSD battery managerment system for more safety and long life.
- The battery can be charged in working gap without take out for longer woring time.



CONVENIENCE

- Working steady and easy exchange the battery in 5s.
- Curtis controller and CAN-bus system for easy to check.
- The controller have the self-diagnosis function and the error code be show on LCD.
- Every cover can be easy to disassembly.



INTELLIGENT HANDLE

- Can-bus handle with all button to easy touch.
- Coded lock inside for more safety.
- The driving speed can be automatic control with different handle angle.



FLEXIBLE AND DURABLE

- Smaller body can be easy to turnover the container and elevator.
- The handle is upright and can be used for walking in a narrow space.
- Lightweight body and guaranteed strength design, 5% energy saving compared to traditional lead-acid battery models.
- Strong power, hight gradeability.



OPTIONS: Sigle loading wheel & 1070/1220/1525mm height Load Brackets.



SPECIFICATION

Specification	Model	1		CLG2015L		CLG2020L	
	Power Type	2		Elctric		Elctric	
	Driving Type	3		Walking		Walking	
	Capacity	4	Q (kg)	1500		2000	
	Load Center	5	c (mm)	600		600	
	Overhang	6	x (mm)	947		951	
	Wheel Base	7	y (mm)	1185		1189	
Weight	Service Weight	8	kg	123	126	149	153
	Loading Axle Load, Driving / Loading	9	kg	500 / 1123	626 / 1000	621 / 1528	625 / 1528
	Unloading Axle Load, Driving / Loading	10	kg	96 / 27	99 / 27	115 / 34	119 / 34
Chassis	Wheel	11		PU		PU	
	Driving Wheel Size	12	x w (mm)	210×70		210×70	
	Loading Wheel Size	13	x w (mm)	80×93(80×70)		80×93(80×70)	
	Balance Wheel Size	14	x w (mm)	80×30		80×30	
	Wheels(x= Driving Wheel) Driving / Loading	15		1x/ 2(1x/ 4) or 1x +2/ 2(1x +2/ 4)		1x/ 2(1x/ 4) or 1x +2/ 2(1x +2/ 4)	
	Driving Tread Width	16	b10 (mm)	-/420		-/420	
	Loading Tread Width	17	b11 (mm)	380	525	380	525
Dimension	Lifting Height	18	h3 (mm)	115		115	
	Handle Height, Min / Max	19	h14 (mm)	700 / 1160		700 / 1160	
	Fork Height	20	h13 (mm)	80		80	
	Overall Length	21	l1 (mm)	1530		1536	
	Body Length	22	l2 (mm)	380		386	
	Overall Width	23	b1 (mm)	540	685	540	685
	Fork Size	24	s/e/l (mm)	47 / 160 / 1150		47 / 160 / 1150	
	Fork Spread	25	b5 (mm)	540	685	540	685
	Min Ground Clearance	26	m2 (mm)	33		33	
	Aisle Width, 800x1200 pallet	27	Ast (mm)	2000		2006	
Performance	Turning Radius	28	Wa (mm)	1330		1336	
	Driving Speed (load / unload)	29	km/h	4.6/ 4.8		4.8/ 5.2	
	Lifting Speed (load / unload)	30	mm/s	20 / 25		17 / 22	
	Lower Speed (load / unload)	31	mm/s	50 / 40		50 / 30	
	Max. Gradeability (load / unload)	32	%	4 / 16		8 / 16	
System	Brake System	33		Electromagnetism		Electromagnetism	
	Driving Motor Power, S2 60min	34	kW	0.65		0.75	
	Lifting Motor Power, S3 10%	35	kW	0.50		0.80	
	Battery According DIN 43531/ 35/ 36 A, B, C Standard	36		No		No	
	Battery Voltage, Capacity, K5	37		24 / 20(24 / 30; 24 / 36)		48 / 20	
	Battery Weight (+/-5%)	38	kg	4.6		7.5	
	Energy Consumption (According VDI)	39	kWh/h	0.18		0.25	
Others	Driving Control Type	40		DC		DC	
	Ear Noise	41	dB(A)	<70		<70	

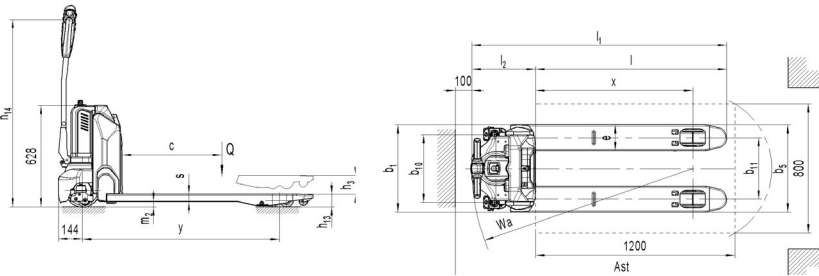

Electric Pallet Truck

Main Features



GREMAN AC DRIVE TECHNOLOGY

- The powerful German Schabmueller maintenance free AC Drive motor in combination with the Greman Kordel gearbox,Intorqe brake and Wicke drive wheel give best performance,efficiency and reliability to reduce the running cost.
- The AC Drive can gives always the right response when gentle or fast acceleration whatever you desired.

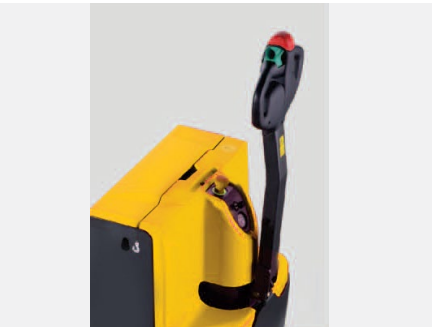

LONG TILLER DESIGN FOR ERGONOMICS AND SAFETY

- In particular through the long tiller design the operator can always keep a safe distance to the truck during proceeding the work very ergonomically.
- The design ensures lower operational forces than trucks with a short tiller.
- The tillers operating height is naturally positioned to ergonomic,operator friendly controlling positions.



MAINTENANCE FRIENDLY

- The trucks design and the used components are tailored to make service and maintenance easy.All components are easy to reach when removing the main cover only with 2 screws,drive-and castor wheel are east to exchange without craning the truck.



LONG LASTING BATTERY

- With the long lasting battery capacities for every model.
- With sideways battery exchange for long operations and multi-shifts.



SPECIFICATION

Feature	Model	1		CLG2016L-WA		CLG2020L-WA		CLG2025L-WA	
	Poer Type	2		Electric		Electric		Electric	
	Driving Type	3		Walking		Walking		Walking	
	Capacity	4	kg	1600		2000		2500	
Dimension	Overall Length	5	mm	1670		1735		1950	
	Overall Wide	6	mm	690		690		690	
	Overall Height	7	mm	1335		1335		1335	
	Min. Height of Fork	8	mm	85		85		85	
	Max. Height of Fork	9	mm	205		205		205	
	Fork	10	mm	1150×173×60					
	Fork Spread	11	mm	540	685	540	685	540	685
	Wheel Base	12	mm	1261		1327		1541	
	Turning Radius	13	mm	1440		1490		1750	
Performance	Driving Speed (load / unload)	14	km/h	5.7 / 6.0		5.7 / 6.0		5.5 / 6.0	
	Lifting Speed (load / unload)	15	mm/s	25 / 35		22 / 30		35 / 45	
	Lowering Speed (load / unload)	16	mm/s	35 / 30		35 / 35		40 / 40	
Motor	Driving Motor Power	17	kw	1.3		1.3		1.7	
	Lifting Motor Power	18	kw	0.8		0.8		2.2	
	Battery Capacity / Voltage	19	Ah/v	160 / 24		210 / 24		350 / 24	
Wheel Dimension	Front Wheel	20	mm	Φ84×84					
	Balance Wheel	21	mm	Φ100×40					
	Driving Wheel	22	mm	Φ230×70					
Weight	Service Weight	23	kg	445		535		720	
	Battery	24	kg	150		215		285	

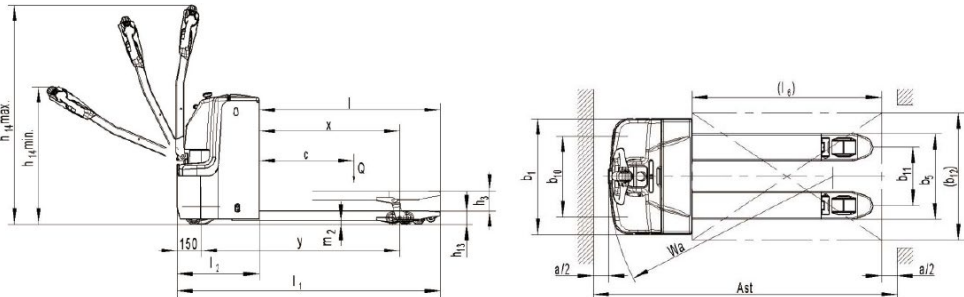

Electric Pallet Truck

Main Features

POWERFUL

- Powerful AC-drive unit from the global industry leaders:the AC driving motor designed motor designed and produced by Schabmuller comes together with the top quality ZF gearbox and it is equipped with Intorq electromagnetic brake.The drive unit can provide the drive speed up to 8km/h.The use of top level quality drive wheels helps to ensure the long life time of PU tires.

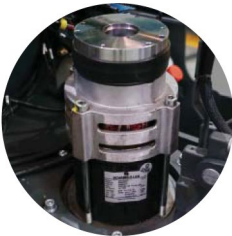

RELIABLE

- The driving controllers and steering controllers are manufactured by Zapi(Italy)-the leading European brand with long history in the industry,which provides extremely reliable and flexible solutions with high performance level of the conrtol system.



COMFORTABLE

- The model range can be equipped with the option of Electric Power Steering(EPS) which delivers precise and fast control for the position of steering wheel and has a high level of reliability as well as safety according off oddicial standards.



ERGONOMICS

- The German Rema tiller delivers high level of ergonomics as well as reliability of control system.In addition, the tiller ensures a long-life-time thanks to the contactless rocker switches designer for lifting/lowering function.



RELIABLE

- The integrated design of operator's platform and protective arms as well as totally new inernal structure allows to ensure the smallest body length of the stackers and provide extremely low turning radius.among competitors. Together with this,the suspension system for the platform helps to provide the high level of comfort to operators.



SPECIFICATION

Feature	Model	1		CLG2020L-R3	CLG2025L-R3
	Power Type	2		Electric	
	Driving Type	3		Standing	
	Capacity	4	kg	2000	2500
Dimension	Overall Length	5	mm	1790	1895
	Overall Wide	6	mm	790	
	Overall Height	7	mm	1350	
	Min. Height of Fork	8	mm	85	
	Max. Height of Fork	9	mm	205	
	Fork	10	mm	1150×173×55	
	Fork Spread	11	mm	540 / 685	
Performance	Wheel Base	12	mm	1330	1435
	Turning Radius	13	mm	1585	1690
	Driving Speed (load / unload)	14	km/h	7.0 / 8.0	6.0 / 7.0
	Lifting Speed (load / unload)	15	mm/s	25 / 30	35 / 45
Motor	Lowering Speed (load / unload)	16	mm/s	30 / 25	45 / 50
	Driving Motor Power	17	kw	1.4	
	Lifting Motor Power	18	kw	0.8	2.2
Wheel Dimension	Battery Capacity / Voltage	19	Ah/v	210 / 24	270 / 24
	Front Wheel	20	mm	Φ84×84	
	Balance Wheel	21	mm	Φ100×40	
	Driving Wheel	22	mm	Φ210×70	
Weight	Service Weight	23	kg	650	770
	Battery	24	kg	185	235

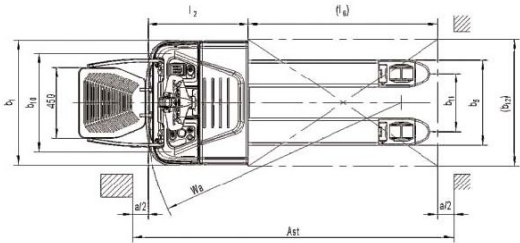
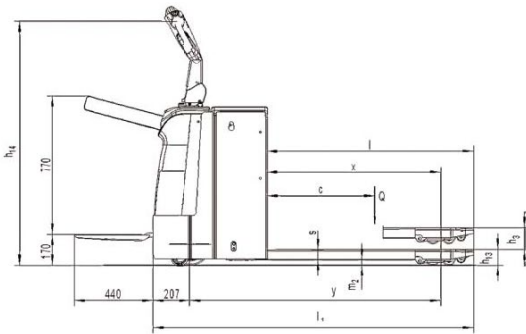



Electric Pallet Truck

Main Features



GENEROUS PLATFORM

- The roomy platform ensures operator comfort throughout the day.



BACKREST

- Heavy duty load backrest with a tilt down design to facilitate battery change out.Optional battery rollers provides easier battery change out.



TRAY

- The optional available tray gives the right place for your work equipment.



ERGONOMIC ROBUST GERMAN TILLER

- The operator friendly robust metal casted German tiller provides maximum of ergonomics and safety in riding-as well as in walking mode.



JOG BUTTON

- Job button on the tiller allows operator to walk beside the truck.Additional sidetracker for travelling in tiller direction to increase productivity in order picking operations.The coast mode allows slowly coasting.



SPECIFICATION

Feature	Model	1		CLG2027L-FL	CLG2036L-FL
	Poer Type	2		Electric	Electric
	Driving Type	3		Pedestrian	Pedestrian
	Capacity	4	kg	2700	3600
Dimension	Overall Length	5	mm	2330	3350
	Overall Wide	6	mm	1095	1095
	Overall Height	7	mm	880/1550	880/1550
	Min. Height of Fork	8	mm	83	83
	Max. Height of Fork	9	mm	150	150
	Fork	10	mm	1220×230×60	2440×255×60
	Fork Spread	11	mm	560685	585710
	Wheel Base	12	mm	1615	2130
	Turning Radius	13	mm	2145	2660
	Driving Speed (load / unload)	14	km/h	11/14	9.5/12
Performance	Lifting Speed (load / unload)	15	mm/s	38/49	30/40
	Lowering Speed (load / unload)	16	mm/s	55/50	45/42
	Driving Motor Power	17	kw	3.8	3.8
Motor	Lifting Motor Power	18	kw	2.2	2.2
	Battery Capacity / Voltage	19	Ah/v	350 / 24	350 / 24
Wheel Dimension	Front Wheel	20	mm	Φ82×82	Φ82×70
	Balance Wheel	21	mm	Φ125×60	
	Driving Wheel	22	mm	Φ310×105	
Weight	Service Weight	23	kg	1070	1150
	Battery	24	kg	320	320

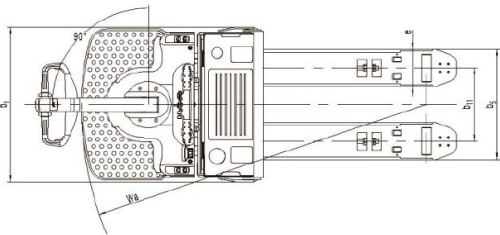
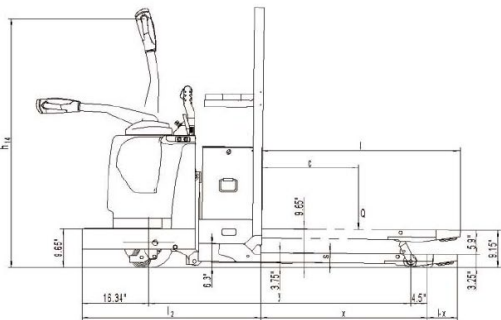



Electric Pallet Stacker

Main Features



BUILT-IN CHARGER

- The built-in charge makes operations more autonomy and increases the operating range.



ROBUST PROFILE

- Robust mast with real mast profiles for perfect stability,accuracy and high lifetime.



POWERFUL BATTERY

- 2x12v 85AH powerful VRLA-AGM main-tenance free batteries.
- Option 2x12V 106AH.



BATTERY DEEP DISCHARGE PROTECTION

- Proofed and ergonomic emergency button and discharge indicator,more robust and reliable than other,The included automatic battery protection ensures high lifetime for the batteries.

PROOFED COMPONENTS

- Proofed components such as sensors,micro-switches,controller and hydraulic power-pack from international brands.

FULFILLING STANDARDS

- Fulfilling the actual valid European standards,also in ISO 13849, performance level.

APPLICATIONS

- Ideal economic solution for all indoor low duty and occasional stacking operations.

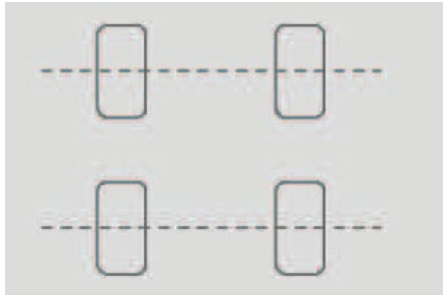

STABILITY

- 4-Wheel design with sideways tiller for excellent view and maneuverability as well as high stability.



SPECIFICATION

Feature	Model	1		CLG2S010-WF3	CLG2S010-WS3
	Power Type	2		Electric	Electric
	Driving Type	3		Walking	Walking, Straddle-leg
	Capacity	4	kg	1000	1000
Dimension	Load Centre	5	mm	600	600
	Overall Length	6	mm	1800	1838
	Overall Wide	7	mm	800	800 / (1170~1470)
	Height of tiller in drive positon min / max	8	mm	785 / 1300	785 / 1300
	Lifting Height	9	mm	2900	2900
	Max. Height of Truck	10	mm	3325	3420
	Full Free Height	11	mm	70	70
	Min. Height of Fork	12	mm	85	40
	Fork	13	mm	1150×150×60	1150×100×35
	Fork Spread	14	mm	570/685	282~800
	Wheel Base	15	mm	1281	1281
	Turning Radius	16	mm	1485	1485
Performance	Driving Speed (load / unload)	17	km/h	4.3/4.5	4.3/4.5
	Lifting Speed (load / unload)	18	mm/s	110/160	110/160
	Max. Lowering Speed (load / unload)	19	mm/s	130/110	130/110
Motor	Driving Motor Power	20	kw	0.45	0.45
	Lifting Motor Power	21	kw	2.2	2.2
Wheel Dimension	Battery Capacity / Voltage	22	Ah/v	85/ 2×12	85/ 2×12
	Front Wheel	23	mm	Φ84×70	Φ84×70
	Steering Wheel	24	mm	Φ124×60	Φ124×60
	Driving Wheel	25	mm	Φ220×70	Φ220×70
Weight	Service Weight	26	kg	510	756
	Battery	27	kg	2×25	2×25

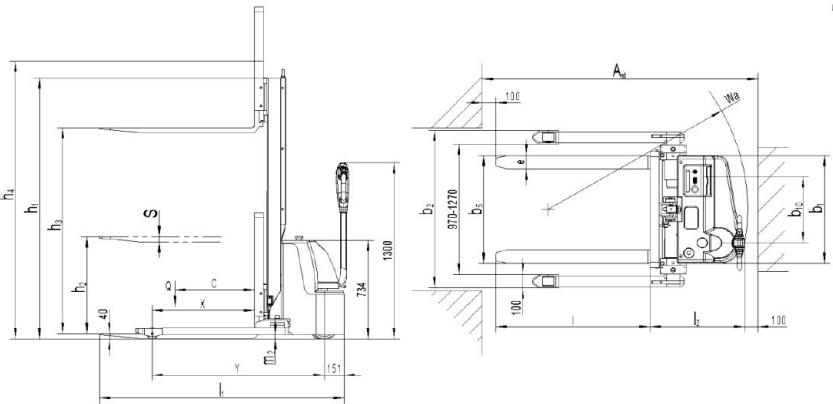

Electric Pallet Stacker

Main Features

- The CLG2S012/16/20-WF3 is tailored to most pedestrian controlled stacking operations with capacities from 1200kg up to 2000kg.
- With the long mounted tiller the operator keeps safe and ergonomic distance to perform his work.
- Due to the gentle operating full proportional lifting system stacking operating becomes more safer and quicker.
- With the high-quality and state of the art top-brand components and technologies,the truck competes with leading well-known brands in the market.



LONG TILLER DESIGN FOR ERGONOMICS AND SAFETY

- In particular through the long tiller design the operator can always keep a safe distance to the truck during proceeding the work very ergonomically.
- The design ensures lowers operational forces than trucks with a short tiller.
- The tiller operating height is naturally positioned to ergonomic,operator friendly controlling positions.
- Specifically staking operations becomes more ergonomically and quicker due to the safe distance and better view to the forks.The 4 wheel design with the sideways long mounted tiller gives particular an exact and perfect view to the forks.



ELECTRONIC PROPORTIONAL LIFTING AND LOWERING

- The electronically controlled proportional lifting system ensures accurate positioning and stacking operations at every lifting height.
- In specific with high masts the electronic controlled proportional lifting performs at its best.

CAN-bus

CANBUS TECHNOLOGY

- the CANBUS technology is due to less wiring more reliable.
- For maintenance the CANBUS technology makes analysis and adjustments easier so that the downtime is lower than for trucks without CANBUS.
- Digital signals further makes parts longer lasting than analogue signals.

SPECIFICATION

Feature	Model	1		CLG2S012-WF3	CLG2S016-WF3	CLG2S020-WF3
	Power Type	2		Electric	Electric	Electric
	Driving Type	3		Walking	Walking	Walking
	Capacity	4	kg	1200	1600	2000
Dimension	Load Centre	5	mm	600	600	600
	Overall Length	6	mm	1919	1964	2100
	Overall Wide	7	mm	820	820	820
	Height of tiller in drive position min / max	8	mm	850 / 1385	850 / 1385	850 / 1385
	Lifting Height	9	mm	2900	2900	2900
	Max. Height of Truck	10	mm	3380	3380	3380
	Full Free Height	11	mm	0	0	0
	Min. Height of Fork	12	mm	90	90	90
	Fork	13	mm	1150×180×60	1150×180×60	1150×180×60
	Fork Spread	14	mm	570/685	570/685	570/685
	Wheel Base	15	mm	1248	1293	1429
	Turning Radius	16	mm	1440	1510	1640
Performance	Driving Speed (load / unload)	17	km/h	6.0/6.0	5.7/6.0	5.4/6.0
	Lifting Speed (load / unload)	18	mm/s	90/140	130/200	130/200
	Max. Lowering Speed (load / unload)	19	mm/s	250/200	280/230	280/230
Motor	Driving Motor Power	20	kw	1.3	1.3	1.7
	Lifting Motor Power	21	kw	1.5	3.2	3.2
	Battery Capacity / Voltage	22	Ah/v	180/24	270/24	350/24
Wheel Dimension	Front Wheel	23	mm	Φ84×70	Φ84×70	Φ84×70
	Steering Wheel	24	mm	Φ150×54	Φ150×54	Φ150×54
	Driving Wheel	25	mm	Φ230×70	Φ230×70	Φ230×70
Weight	Service Weight	26	kg	1007	1340	1579
	Battery	27	kg	175	230	288

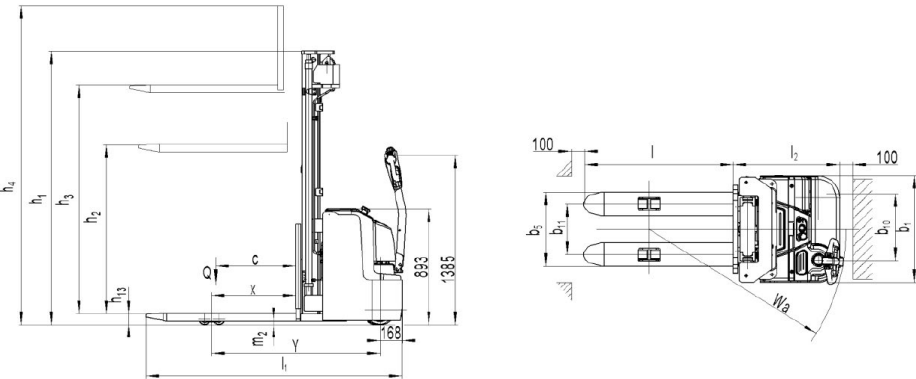

Straddle-leg Electric Pallet Stacker

Main Features

- Ergonomic, Compact and safe Long Tiller Design.
- Precise Lifting and Lowering with Full Proportional Hydraulic System.
- Core Components from Top Quality Brands.
- 4 Wheel Structure for Stability.



LONG TILLER DESIGN FOR ERGONOMICS AND SAFETY

- Specifically stacking operations becomes more ergonomically and quicker due to the safe distance and better view to the forks. The 4 Wheel design with the sideways long mounted tiller gives particular an exact and perfect view to the forks.



STRADDLE LEG

- Adjustable straddle leg design, suitable for diverse pallet sizes and more stability.



FOR EVERY APPLICATION THE RIGHT BATTERY CAPACITY

- With the long lasting battery capacities for every model.
- With sideways battery exchange for long operations and multi-shifts.

ELECTRONIC PROPORTIONAL LIFTING AND LOWERING

- The electronically controlled proportional lifting system ensures accurate positioning and stacking operations at every lifting height.
- In specific with high masts the electronic controlled proportional lifting performs at its best.



SPECIFICATION

Feature	Model	1		CLG2S016-WS3	CLG2S020-WS3
	Power Type	2		Electric	Electric
	Driving Type	3		Walking, Straddle-leg	Walking, Straddle-leg
	Capacity	4	kg	1600	2000
Dimension	Load Centre	5	mm	600	600
	Overall Length	6	mm	2004	2135
	Overall Wide	7	mm	820 /(1220~1520)	820 /(1220~1520)
	Height of tiller in drive position min / max	8	mm	850 / 1385	850 / 1385
	Lifting Height	9	mm	2900	2900
	Max. Height of Truck	10	mm	3380	3380
	Full Free Height	11	mm	0	0
	Min. Height of Fork	12	mm	50	50
	Fork	13	mm	1150×120×40	1150×120×40
	Fork Spread	14	mm	255~730	255~730
	Wheel Base	15	mm	1378	1490
	Turning Radius	16	mm	1680	1790
Performance	Driving Speed (load / unload)	17	km/h	5.7/6.0	5.4/6.0
	Lifting Speed (load / unload)	18	mm/s	130/200	130/200
	Max. Lowering Speed (load / unload)	19	mm/s	200/140	200/140
Motor	Driving Motor Power	20	kw	1.3	1.7
	Lifting Motor Power	21	kw	3.2	3.2
	Battery Capacity / Voltage	22	Ah/v	270/24	350/24
Wheel Dimension	Front Wheel	23	mm	Φ84×70	Φ84×70
	Steering Wheel	24	mm	Φ150×54	Φ150×54
	Driving Wheel	25	mm	Φ230×70	Φ230×70
Weight	Service Weight	26	kg	1460	1700
	Battery	27	kg	230	288

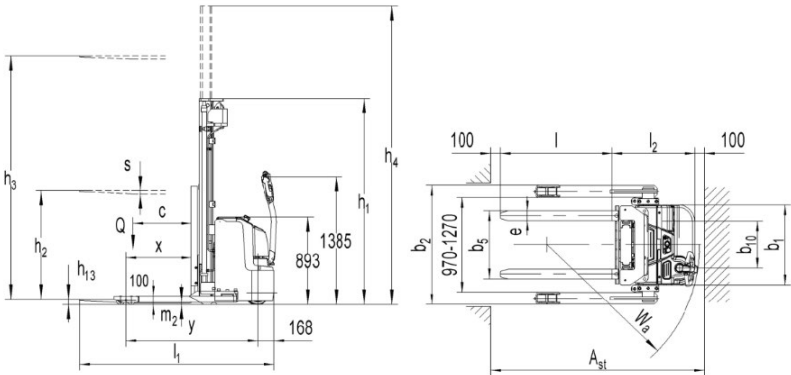

Electric Pallet Stacker

Main Features

POWERFUL

- Powerful AC-drive unit from the global industry leaders:the AC driving motor designed motor designed and produced by Schabmuller comes together with the top quality ZF gearbox and it is equipped with Intorq electromagnetic brake.The drive unit can provide the drive speed up to 8km/h.The use of top level quality drive wheels helps to ensure the long life time of PU tires.



RELIABLE

- The driving controllers and steering controllers are manufactured by Zapi(Italy)-the leading European brand with long history in the industry,which provides extremely reliable and flexible solutions with high performance level of the control system.



COMFORTABLE

- The model range can be equipped with the option of Electric Power Steering(EPS) which delivers precise and fast control for the position of steering wheel and has a high level of reliability as well as safety according off oddicial standards.



ERGONOMICS

- The German Rema tiller delivers high level of ergonomics as well as reliability of control system.In addition, the tiller ensures a long-life-time thanks to the contactless rocker switches designer for lifting/ lowering function.



SPECIFICATION

Feature	Model	1		CLG2S012-RF	CLG2S016-RF	CLG2S020-RF
	Power Type	2		Electric	Electric	Electric
	Driving Type	3		Standing	Standing	Standing
	Capacity	4	kg	1200	1600	2000
Dimension	Load Centre	5	mm	600	600	600
	Overall Length	6	mm	1855	1896	2025
	Overall Wide	7	mm	790	790	790
	Overall Height	8	mm	2308	2308	2308
	Lifting Height	9	mm	3530	3530	3530
	Max. Height of Truck	10	mm	4088	4088	4088
	Full Free Height	11	mm	1760	1760	1760
	Min. Height of Fork	12	mm	90	90	90
	Fork	13	mm	1150×180×60	1150×180×60	1150×180×60
	Fork Spread	14	mm	570 / 685	570 / 685	570 / 685
Performance	Wheel Base	15	mm	1167	1215	1327
	Turning Radius	16	mm	1380	1420	1550
	Driving Speed (load / unload)	17	km/h	7.0 / 8.0	7.0 / 8.0	6.0 / 7.0
	Lifting Speed (load / unload)	18	mm/s	90 / 100	90 / 140	90 / 140
Motor	Max. Lowering Speed (load / unload)	19	mm/s	25 / 20	25 / 20	25 / 20
	Driving Motor Power	20	kw	1.4	1.4	1.4
	Lifting Motor Power	21	kw	1.5	3.2	3.2
Wheel Dimension	Battery Capacity / Voltage	22	Ah/v	180 / 24	270 / 24	350 / 24
	Front Wheel	23	mm	Φ85×75	Φ85×75	Φ85×75
	Steering Wheel	24	mm	Φ150×54	Φ150×54	Φ150×54
	Driving Wheel	25	mm	Φ230×70	Φ230×70	Φ230×70
Weight	Service Weight	26	kg	1080	1380	1620
	Battery	27	kg	175	230	288

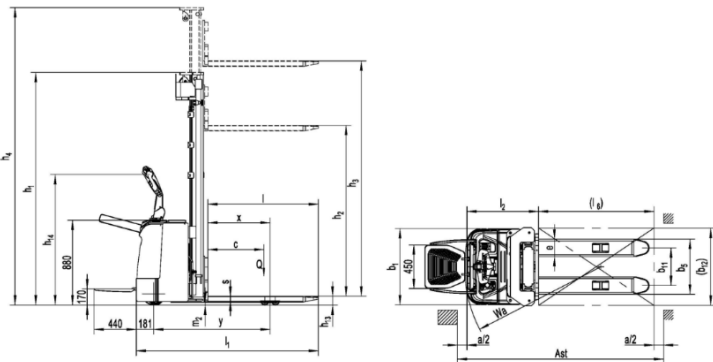

Electric Reach Truck

Main Features

COMFORTABLE AND BEAUTIFUL DESIGN

- Modern and new design in Modern design of control pedal,and the damping pedal with ergonomic design ensures comfortable driving.

MAST SYSTEM

- The mast has the reach forward function which allows the truck to store the goods without moving of the truck itself,which is convenient and safe;High quality imported C-shape mast ensures that the vehicle load capacity.

EMERGENCY BUTTON

- Safe and convenient configuration of the emergency button,emergency one-time cut off all energy,which greatly increase safety.



BUFFER SYSTEM FOR FORK LOWEING AND MAST FORWARD/BACKWARD

- Buffer system for fork loweing and mast forward/backward increase vehicle safety and operating comfort.

ELECTRONIC CONTROL FUNCTIONS

- The electrical energy,timing fault display is easy for operator to understand the vehicle condition and to have maintenance,The surface of electrical components is water and dust proof,the design of fully enclosed thermal of the central control unit to make the circuit more simple and reliable.



SPECIFICATION

Feature	Model		1		CLG2R015-M
	Power Type		2		Electric
	Driving Type		3		Standing
	Capacity		4	kg	1500
	Load Centre		5	mm	500
Dimension	Overall Length		6	mm	2280
	Overall Wide		7	mm	1260
	Height of the Overhead		8	mm	2260
	Forward Distance		9	mm	570
	Max. Lifting Height		10	mm	5000
	Overall Height		11		2335
	Max. Height of Truck		12	mm	5915
	Full Free Height		13	mm	1420
	Fork (Thickness×Wide×Length)		14	mm	35×120×1070
	Fork Spread		15	mm	240-760
	Fork Tilted Angle		16	°	2 / 4
	Min. Gound Clearance		17	mm	75
	Aisle Wide	800×1200 pallet	18	mm	2700
	Tread Width		19	mm	1124
	Overhang		20	mm	180
Performance	Turning Radius		21	mm	1600
	Driving Speed (load / unload)		22	km/h	10.5 / 10.5
	Lifting Speed (load / unload)		23	mm/s	270 / 380
	Lowering Speed (load / unload)		24	mm/s	400 / 350
	Forward Speed (load / unload)		25	mm/s	100 / 100
	Max. Gradeability (load / unload)		26	%	10 / 15
Wheel	Front Wheel		27	mm	Φ267x135
	Driving Wheel		28	mm	Φ313x125
Motor	Driving Motor Power		29	kw	6.4
	Lifting Motor Power		30	kw	12.5
	Battery Capacity / Voltage		31	Ah/v	360 / 48
Weight	Service Weight		32	kg	3000
	Battery		33	kg	750

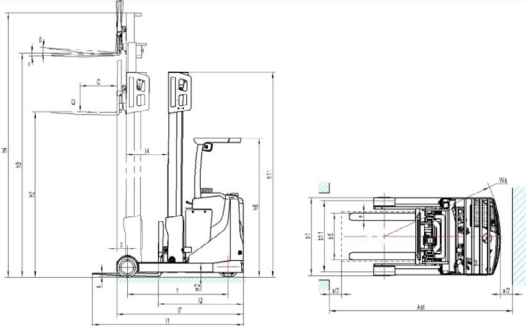

Electric Reach Truck

Main Features

CLG2R020-M Series Reach stack is an ideal option for high capacity and high lift height cargo storage application.Rated load capacity of 2000kg lifting height up to 8000mm It has the advantages of the integrated reach forward mast and small turning radius,which can ignore the barriers of the bottom shelf.It is applicable to large-scale vertical chemical plants,warehouses,supermarkets,docks and places for goods storage.

COMFORTABLE AND BEAUTIFUL DESIGN

- Modern and new design in Modern design of control pedal, and the damping pedal with ergonomic design ensures comfortable driving.



MAST SYSTEM

- The mast has the reach forward function which allows the truck to store the goods without moving of the truck itself,which is convenient and safe;high quality imported C-shape mast ensures that the vehicle load capacity.

EMERGENCY BUTTON

- safe and convenient configuration of the emergency button,emergency one-time cut off all energy,which greatly increase safety.

BUFFER SYSTEM FOR FORK LOWERING AND MAST FORWARD/BACKWARD

- Buffer system for fork lowering and mast forward/backward increase vehicle safety and oprating comfort.

ELECTRONIC CONTROL FUNCTIONS

- The electrial energy,timing,fault display is easy for operator to understand the vehicle condition and to have maintenance.the surface of electrical components is water and dust proof,the design of fully enclosed thermal of the central control unit to make the ciruit more simple and reliable.



SPECIFICATION

Feature	Model		1		CLG2R020-M
	Power Type		2		Electric
	Driving Type		3		Standing
	Capacity		4	kg	2000
	Load Centre		5	mm	500
Dimension	Overall Length		6	mm	2380
	Overall Wide		7	mm	1260
	Height of the Overhead		8	mm	2260
	Forward Distance		9	mm	645
	Max. Lifting Height		10	mm	5000
	Overall Height		11		2335
	Max. Height of Truck		12	mm	5915
	Full Free Height		13	mm	1420
	Fork (Thickness×Wide×Length)		14	mm	40×120×1070
	Fork Spread		15	mm	240-760
	Fork Tilted Angle		16	°	2 / 4
	Min. Gound Clearance		17	mm	75
	Aisle Wide	800×1200 pallet	18	mm	2800
	Tread Width		19	mm	1155
	Overhang		20	mm	208
Performance	Turning Radius		21	mm	1750
	Driving Speed (load / unload)		22	km/h	10.5 / 10.5
	Lifting Speed (load / unload)		23	mm/s	270 / 380
	Lowering Speed (load / unload)		24	mm/s	450 / 400
	Forward Speed (load / unload)		25	mm/s	100 / 100
	Max. Gradeability (load / unload)		26	%	10 / 15
Wheel	Front Wheel		27	mm	Φ330x100
	Driving Wheel		28	mm	Φ343x140
Motor	Driving Motor Power		29	kw	6.4
	Lifting Motor Power		30	kw	12.5
	Battery Capacity / Voltage		31	Ah/v	420 / 48
Weight	Service Weight		32	kg	3250
	Battery		33	kg	939

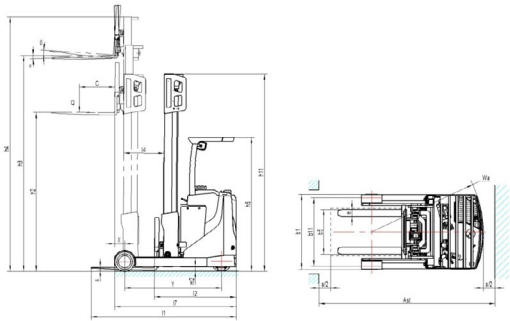



Seated Type Battery Reach Truck

Main Featrues

- This series Sit-on Reach Truck is a high performance truck with high efficiency and excellent safety.It is design to cope with the most demanding stacking operations for goods between 1400kg and 2000kg with maximum lift height up to 8m or 10.5M. Equipped with intelligent system and integrated with safety components to ensure the mose efficient oprations in big warehouses.

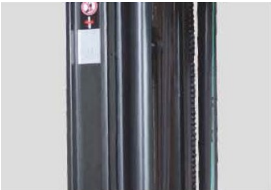

- Germany-imported HOESCH channel steel mast for excellent stability.



- Geman Schabmuller Drive motor and steering motor.
- American KDS Lifting pump for smooth and safe lifting and lowering.



- American Curtis Controller for smooth and smart control with diagnosable signals.



- Germany-imported ZF gear box for excellent acceleration.

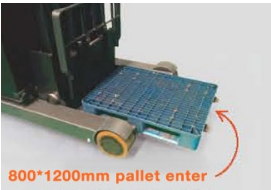

- High Efficiency
- The inner diameter of the legs allows the 800X1200mm pallet enter,no need to reach forward to lower the pallet to the ground.



- High capacity battery with low energy consumption.
- HighCapacity battery optional 360/480/600AH.low energy consumption with approximately 2.52kwh/h,20% energy saving comparing to competiors.



- Ergonomic design
- Comfortable adjustable seat allows the operator to find the best position and reduce fatigue for long time operation,overhead guard gives operator protection as well as.

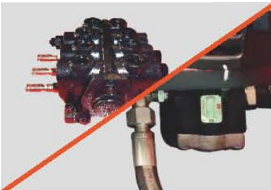

- Japanese Shimadzu Multi Control Valve for accurate and safe control of the hydraulics.



SPECIFICATION

Feature	Model		1		CLG2R014-SM	CLG2R016-SM	CLG2R020-SM
	Power Type		2		Electric	Electric	Electric
	Driving Type		3		Seated	Seated	Seated
	Capacity		4	kg	1400	1600	2000
	Load Centre		5	mm	600	600	600
Dimension	Overall Length		6	mm	2280	2300	2380
	Overall Wide		7	mm	1260	1260	1260
	Height of the Overhead		8	mm	2160	2160	2160
	Forward Distance		9	mm	570	595	645
	Max. Lifting Height		10	mm	5000	5000	5000
	Overall Height		11		2335	2335	2335
	Max. Height of Truck		12	mm	5915	5915	5915
	Full Free Height		13	mm	1420	1420	1420
	Fork (Thickness×Wide×Length)		14	mm	40×120×1070	40×120×1070	40×120×1070
	Fork Spread		15	mm	240-760	240-760	240-760
	Fork Tilted Angle		16	°	2 / 4	2 / 4	2 / 4
	Min. Gound Clearance		17	mm	75	75	75
	Aisle Wide	800×1200 pallet	18	mm	2700	2730	2800
	Tread Width		19	mm	1124	1124	1155
	Overhang		20	mm	180	180	208
	Turning Radius		21	mm	1600	1650	1750
Performance	Driving Speed (load / unload)		22	km/h	10.5 / 10.5	10.5 / 10.5	10.5 / 10.5
	Lifting Speed (load / unload)		23	mm/s	270 / 380	270 / 380	300 / 450
	Lowering Speed (load / unload)		24	mm/s	400 / 350	400 / 350	450 / 400
	Forward Speed (load / unload)		25	mm/s	100 / 100	100 / 100	100 / 100
	Max. Gradeability (load / unload)		26	%	10 / 15	10 / 15	10 / 15
Wheel	Front Wheel		27	mm	Φ267x135	Φ267x135	Φ330x100
	Driving Wheel		28	mm	Φ343x140	Φ343x140	Φ343x140
Motor	Driving Motor Power		29	kw	6.4	6.4	6.4
	Lifting Motor Power		30	kw	12.5	12.5	12.5
	Battery Capacity / Voltage		31	Ah/v	360 / 48	360 / 48	480 / 48
Weight	Service Weight		32	kg	2950	3000	3550
	Battery		33	kg	750	750	939

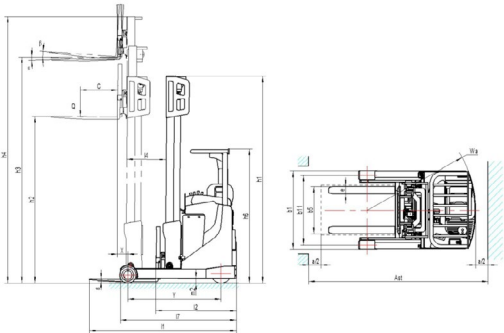

Hand Pallet Truck

Main Features

- Import Seal and chromate-trealed piston rod.
- Easily steering 200°.
- Heavy duty design for moving heavy load.
- Unique hydraulic pump with less effort to lift heavy load easily.
- Conforms to CE safety standard.



SPECIFICATION

Feature	Model		1		CLG2025MJ	CLG2030MJ
	Power Type		2		Manual	Manual
	Driving Type		3		Walking	Walking
	Capacity		4	kg	2500	3000
Dimension	Overall Length		5	mm	1540 / 1630	1540 / 1630
	Overall Wide		6	mm	550 / 685	550 / 685
	Min. Height of Fork		7	mm	75	
	Max. Height of Fork		8	mm	188	
	Fork	Length	9	mm	1150 / 1220	1150 / 1220
		Wide	10	mm	160	160
Weight	Service Weight		11	kg	65 / 70	70 / 75

Semi-Electric Pallet Stacker

Main Features

- Powerful hydraulic system reaction sensitivity with compact struture.
- The imported motor relais can move quickly and strong actuation for a long working time.
- Press the emergent switch can cut down the power and ensure the operator and equiment safety when in a emergency circumstances.
- Special control lever can steer easy and convenience.

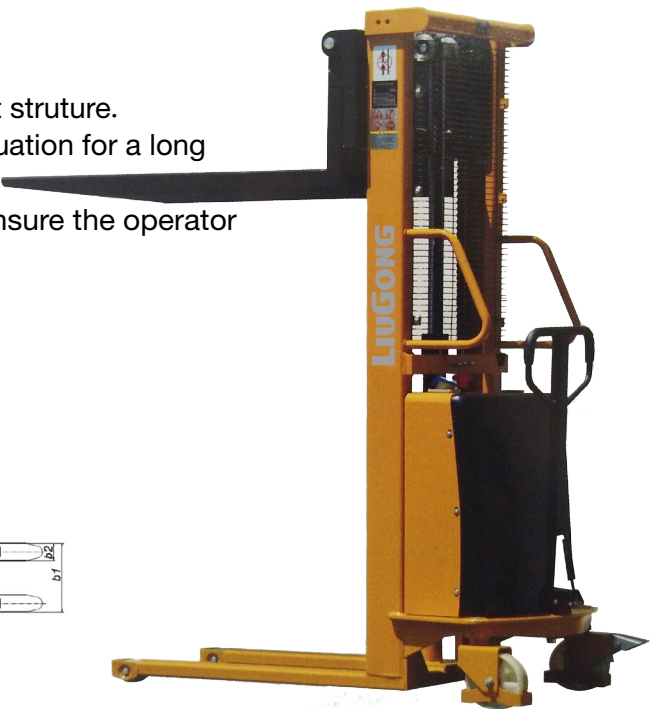
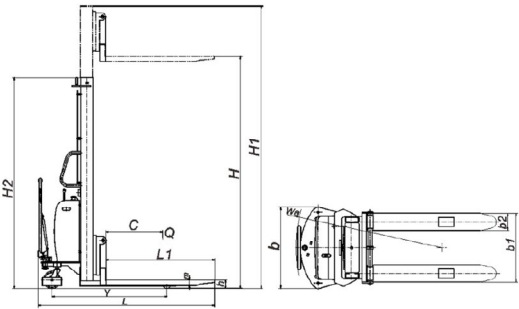

SPECIFICATION

Feature	Model	1		CLG2010H-WFS / CLG2015H-WFS						CLG2020H-WFS	
	Power Type	2		Semi-Electric							
	Driving Type	3		Walking							
	Capacity	4	kg	1000 / 1500						2000	
	Load Centre	5	mm	600							
Dimension	Overall Length	6	mm	1880							
	Overall Width	7	mm	800	800	800	1000	1000	1000	1600	2000
	Lifting Height	8	mm	1600	2500	2900	3100	3300	3500	1600	2500
	Max. Height of Truck	9	mm	2090	3030	3430	3630	3830	4030	2077	2567
	Overall Height	10	mm	1077	1800	2025	2125	2225	2325	2077	2327
	Min. Height of Fork	11	mm	90							
	Fork	12	mm	1150×160×56							
	Fork Spread	13	mm	640							
	Turning Radius	14	mm	1485							
Motor	Driving Motor Power	15	kw	1.5							
	Battery Capacity / Voltage	16	Ah/v	120 / 12							
Weight	Service Weight (without battery)	17	kg	330/355	387/422	414/449	425/460	434/469	443/478	385	420
	Battery Weight	18	kg	27.5							



Standing Type Electric Tow Tractor

Main Featrues

- Compact structure,solid frame with strong traction power.
- Large capacity battery,keeps long-time working.
- Top quality control system from Curtis,makes the truck reacts quickly and operates easily.
- Optional EPS electric power steering system for easy to steering.
- Large and comfortable operation space. The back cushion can be adjust up and down.

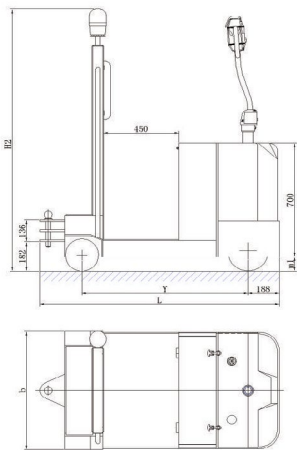

SPECIFICATION

Feature	Model	1		CLG2020L-CT	CLG2030L-CT
	Power Type	2		Electric	
	Driving Type	3		Standing	
	Capacity	4	kg	2000	3000
Dimension	Overall Length	5	mm	1400	
	Overall Wide	6	mm	730	
	Overall Height	7	mm	1660	
	Standing Area	8	mm	500×680	
	Backboard	9	mm	730×1080	
	Wheel Base	10	mm	920	
	Min. Gound Clearance	11	mm	80	
Performance	Turning Radius	12	mm	1180	
	Driving Speed (load / unload)	13	km/s	5.8 / 7.0	
Motor	Power	14	Ah/v	1.5	2.2
	Battery Capacity / Voltage	15	kg	210/24	
Wheel	Front Wheel	16	mm	Φ230×70	
	Rear Wheel	17	mm	Φ200×80	
	Balanced Wheel	18	mm	Φ100×45	
Weight	Service Weight (without battery)	19	kg	535	
	Battery	20	kg	185	

Seated Type Electric Tow Tractor

Main Features

- The appearance of unique,luxury generous.
- Imported AC control technology,excellent performance,reliability,high efficiency,prolong the using time of battery,the longer service life.
- AC motor maintenance free,high speed with high torque output performance,good high speed performance,especially the electric braking performance at high speed.
- Optional EPS electric power steering system for easy to steering.
- Strong climbing ability and traction ability.
- The steering is light and flexible with automatic return.,easy to deal with logistics transport narrow site.
- The tow tractor is simple and convenient to operate, and the driving is smooth and comfortable.

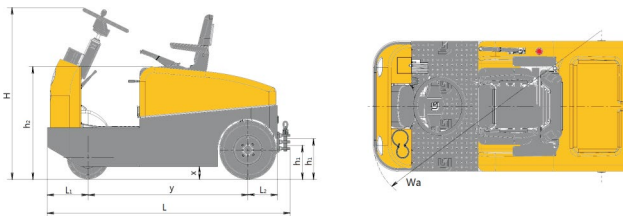

SPECIFICATION

Feature	Model	1		CLG2020T-TS	CLG2030T-TS	CLG2040T-TS	CLG2050T-TS	CLG2060T-TS
	Power Type	2		Electric	Electric	Electric	Electric	Electric
	Driving Type	3		Seated	Seated	Seated	Seated	Seated
	Capacity	4	kg	2000	3000	4000	5000	6000
Dimension	Overall Length	5	mm	1730	1730	1880	1880	1880
	Overall Wide	6	mm	800	800	800	800	800
	Overall Height	7	mm	1190	1190	1190	1190	1190
	Wheel Base	8	mm	1140	1140	1290	1290	1290
	Rear Overhang	9	mm	299	299	299	299	299
	Min. Gound Clearance	10	mm	80	80	80	80	80
	Turning Radius	11	mm	1588	1588	1748	1748	1748
Performance	Min. Right-angle aisle wide	12	mm	1778	1778	1938	1938	1938
	Driving Speed	13	km/s	8	8	8	8	8
Motor	Max. Gradeability	14	%	10	10	10	10	10
	Power	15	kw	2	2	4.5	4.5	4.5
Weight	Battery Capacity / Voltage	16	Ah/v	165 / 48	210 / 48	275 / 48	300 / 48	350 / 48
	Service Weight (without battery)	17	kg	390	395	490	485	495
	Battery	18	kg	350	415	500	525	615